

A820-NIC-DANTE -- Dante Network Interface Card

General Description

The A820-NIC-Dante is a network interface that transmits Dante digital audio with standard IP data. This card replaces a standard network interface in the Shure SCM820 Digital Automixer. Once installed, the SCM820 can network digital audio with any Dante device.

Included Parts

- A820-NIC-Dante Network Interface
- Dante nameplate

Installing the Dante Card into the SCM820

Caution

These servicing instructions are for use by qualified service personnel only. To reduce the risk of electric shock, do not perform any servicing other than that contained in the operating instructions unless you are qualified.

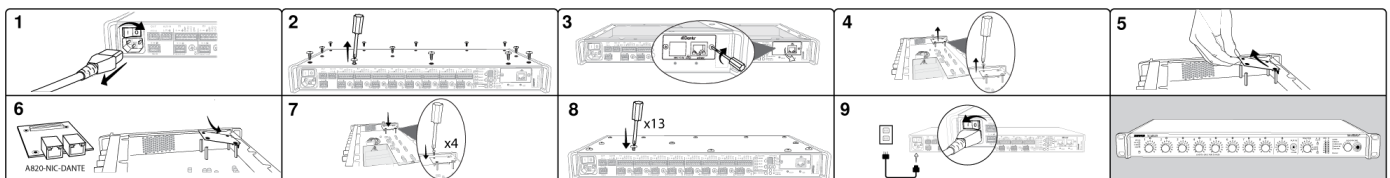

1. Power off and unplug the SCM820 from AC power.
2. Unscrew and remove the top cover.
3. Unscrew the standard nameplate from the back panel and replace with the Dante nameplate.
4. Locate the network card and unscrew it from the four standoffs.
5. Lift up on the card up to disconnect it from the main board.
6. Position the Dante card to align with the connector on the motherboard. Gently push down on the card to seat it into the connector.

7. Replace the screws. Be sure the screws are tight.
8. Replace the top cover and screw it down. Use all screws and ensure they are tight.
9. Plug in the unit and power on.

Additional Information

For information on the SCM820, Dante Virtual Soundcard and Dante Controller software, reference the user guide supplied with the mixer and found electronically on www.shure.com.