

## DJControl Inpulse 300 Easy to use

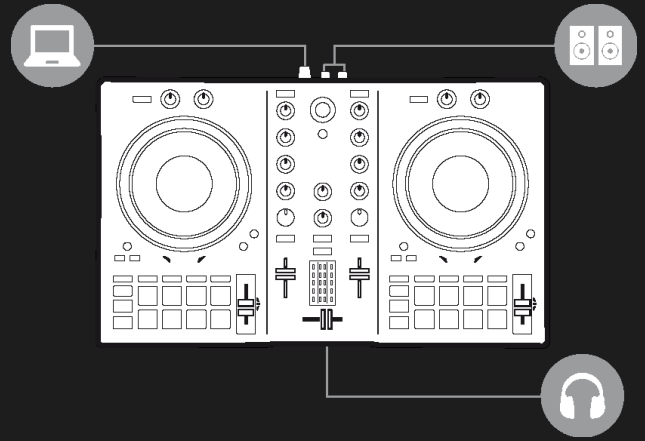

### 1. Install the DJ equipment

#### CONNECT

- The computer to the power outlet
- USB cable to DJControl Inpulse 300
- USB cable to the computer
- Speaker cables to DJControl Inpulse 300 master output and speaker inputs
- Headphones to DJControl Inpulse 300 headphones' output (on front panel of DJControl Inpulse 300)

#### INSTALL

- Download DJUCED  
<https://www.djuced.com>
- Install DJUCED on the computer
- Copy songs on the computer, for example on Windows or macOS Music folder

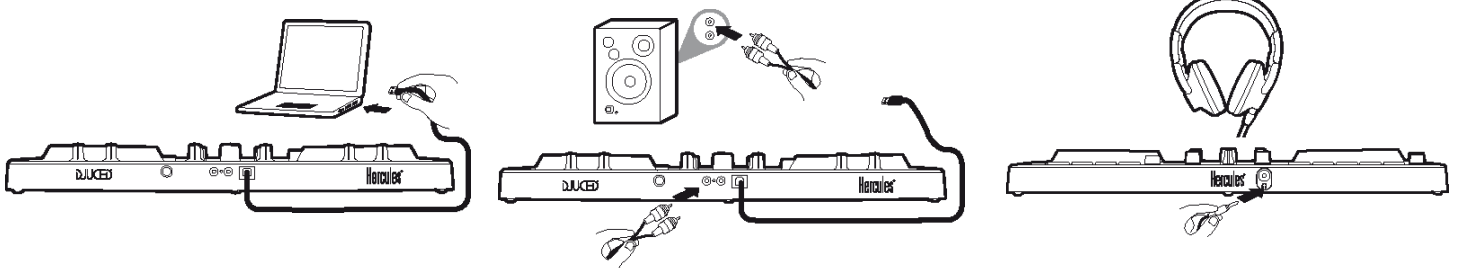

### 2. Prepare DJUCED and DJControl Inpulse 300

#### PREPARE DJUCED

- Run DJUCED.
- Add your own tracks to DJUCED by browsing in Library > Explorer > in the folder you store your songs in, in the Music folder.
- Analyze the songs in DJUCED:
  - Select the songs (shift + mouse).
  - Right-click: BPM > Analyze.
- In DJUCED Song Library > Demo Songs,
  - Load House Loop 1 on deck 1.
  - Load House Loop 2 on deck 2.

#### PREPARE DJCONTROL IMPULSE 300

- Check the BEATMATCH GUIDE key on DJControl Inpulse 300 is lit up.
 
- Move the tempo faders on deck 1 & deck 2 to the central position: a green LED will light up.
- Set both volume faders to 75%.
- Set Filter, Low, Mid, High, Gain, Headphones and Master rotary knobs to mid position.
- Set the crossfader fully to the left to hear deck 1 on master output.

## 3. Follow lights to set the BPM with the tempo fader

- Press Play on deck 1.
- A red light alongside the tempo fader on Deck 2 shows the direction to drag the fader, to set Deck 2's track to the same BPM.
- Move the Tempo Fader up or down, in the direction of the red light.
- If the direction of the red light changes, move the fader slowly in the opposite direction.
- When the red lights on the up/down fader blink, stop moving the tempo fader.
- Both red lights off: the BPM is set.

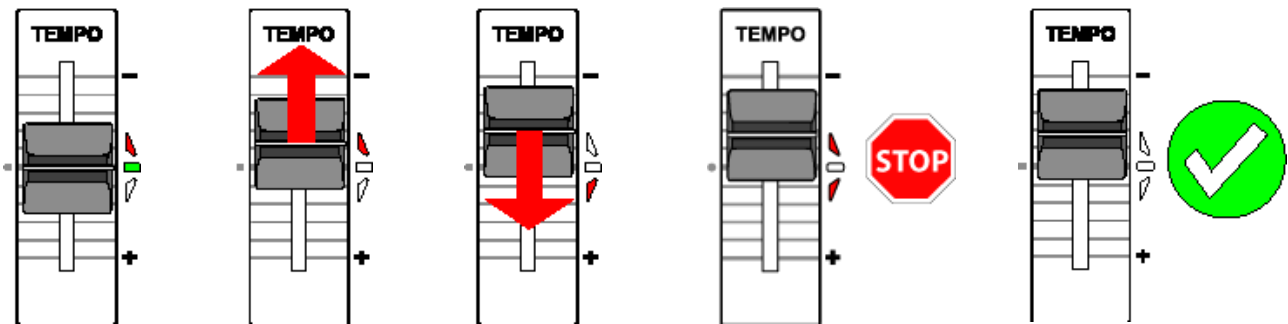

DJUCED shows the same BPM on deck 1 and deck 2: **TEMPO-MATCH**

## 4. Follow lights to align the beats with the jog-wheel

- Press Play on deck 2.
- A red light below the jog wheel on deck 2 shows the direction to turn the wheel, to align deck 2's beats with deck 1's beats.
- Turn the wheel in the direction of the red light.
- If the direction of the red light changes, turn the wheel slowly in the opposite direction.
- As soon as the red lights on the left and right go off, stop: the beats are aligned.

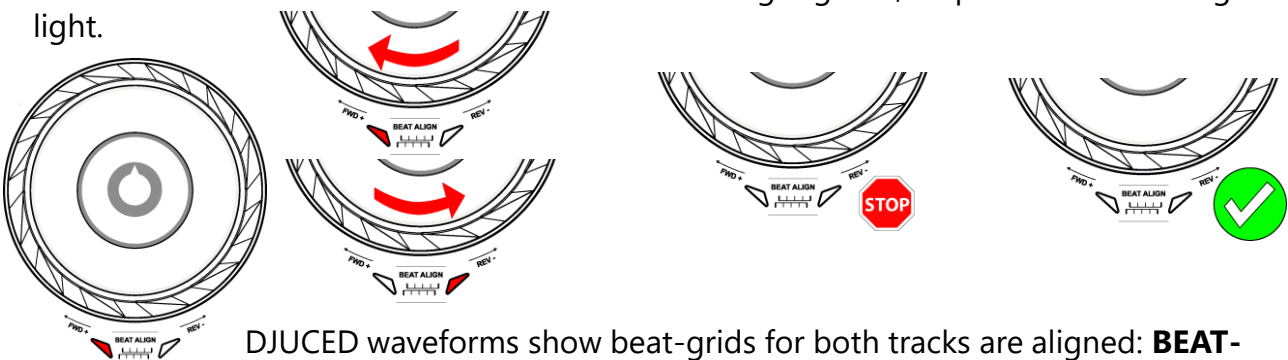

DJUCED waveforms show beat-grids for both tracks are aligned: **BEAT-MATCH**

## 5. Make a smooth transition with the crossfader

### FROM LEFT (DECK 1) TO CENTER

- Move the crossfader gradually from left (Deck 1) to the central position.
- When the crossfader reaches the center, you hear both tracks mixed together.
- Pause a few seconds when the crossfader reaches the center: both tracks are synchronized with beats playing together.

### FROM CENTER TO RIGHT (DECK 2)

- Move the crossfader gradually from the center to the right.
- When the fader is all the way to the right, the transition is complete: you did a smooth transition from deck 1 to deck 2.

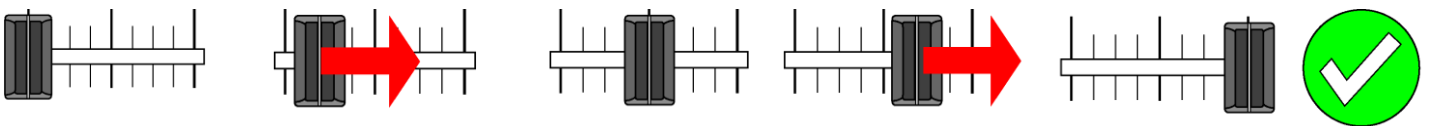

DJs may add effects, such as a filter, over one song during the transition, but it is not necessary if both tracks are in a key that is compatible, such as House Loop 1 and House Loop 2.

## 6. Find next song with Intelligent Music Assistant (IMA)

- Press the Play/Pause button to stop the playback on deck 1.
- Press the Assistant key once, below the Browser rotary button.
- The Assistant key and the base around the Browser light up.
- DJUCED browser shows a list of tracks, selected by the Assistant.
- IMA selects tracks with a key, BPM and energy that fit with the song currently playing.
- Move through the list on the Browser Cap.

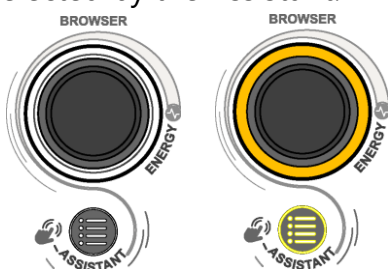

## 7. Further use of the Intelligent Music Assistant (IMA)

### SELECT ENERGY

Energy is song danceability, from cool to hot.

- To select Energy for the assistant suggestions, from cool (dark blue) to hot (red): hold the Assistant key pressed down while turning the Browser cap.
  - The color of the ring at the base of the Browser knob reflects the requested energy.
  - If there are tracks at this energy, with keys and BPMs that fit your current master track, these will be added to the list in Assistant.

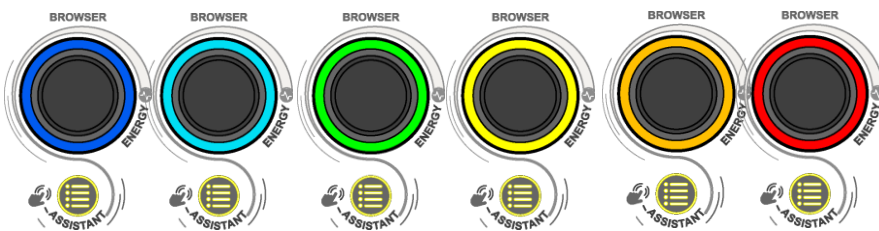

### CLOSE THE ASSISTANT

- To close the IMA and the Assistant list, press the Browser button.

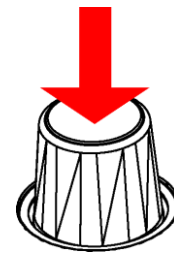

- The backlights on the Assistant key and the ring at the base of the Browser will be switched off.



## 8. DJ Academy (if you are connected to the internet)

### CALL THE DJ ACADEMY

- In DJUCED, on the right of the browser, you can see a smiley wearing a graduation hat.
- Click on it to call the DJ Academy video tutorials in DJUCED.



### BROWSE THE ACADEMY

- The DJ Academy lets you select the lessons you are looking for.

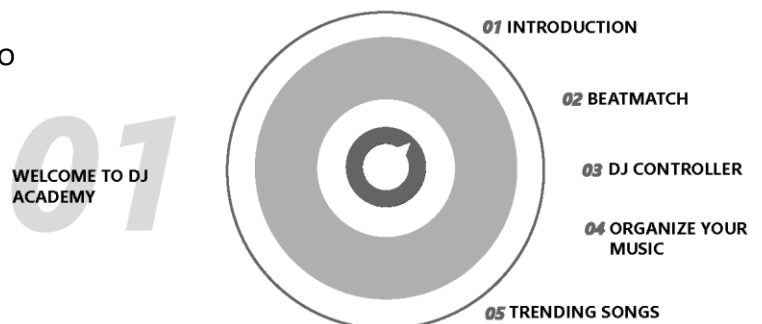

- Select 02 Beatmatch, and play "How to Use the Pitch Fader" to revise usage of the tempo fader (step 3 in this demo).

DJ Academy in DJUCED = first DJ software with video lessons embedded in the DJ software.